

DATE	REVISION
A 11.10.12	PLAN UPDATED FOLLOWING FSO SURVEY
B 23.1.13	R103 CHANGED TO 'STORE' FOLLOWING HSC SURVEY RETURN
C 5.1.17	EXTINGUISHER POSITIONS & TYPES UPDATED
D 20.2.18	R107, R113, R116 & R118 UPDATED TO 'VACANT'
E 11.12.18	R104 & R118 UPDATED TO 'STAFF'

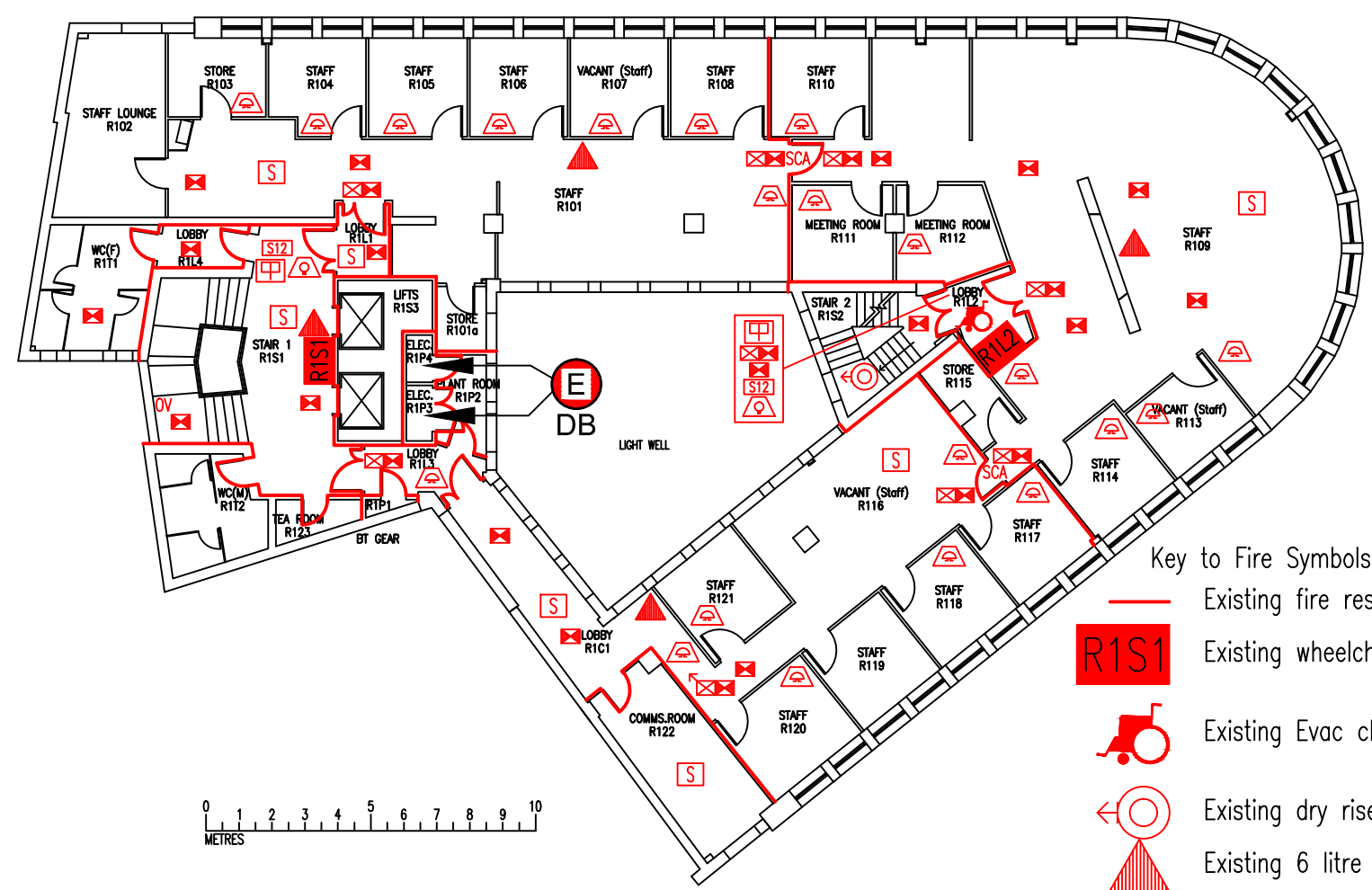

Key to Existing Services Symbols :

- E** Electric distribution board
- DB**

- Key to Fire Symbols
- Existing fire resisting construction 30 min.
 - R1S1** Existing wheelchair refuge zone
 - Existing Evac chair
 - Existing dry riser outlet
 - Existing 6 litre P50 foam fire extinguisher
 - Existing call point – manual
 - Existing exit sign – internally illuminated
 - Denotes directional arrow on existing fire exit sign
 - Existing emergency lighting luminaire – self contained
 - Existing smoke detector
 - Existing fire action sign – general
 - Existing audible warning device – bell
 - Existing visual warning device
 - OV** Existing opening vent (manual)
 - SCA** Existing self closing automatic release

THIS FIRE SAFETY PLAN IS GENERALLY BASED ON INFORMATION PROVIDED BY BU'S FIRE SAFETY OFFICER. IT IS THE RESPONSIBILITY OF ALL USERS OF THIS PLAN TO CHECK THE INFORMATION PROVIDED TO CONFIRM THE EXACT POSITIONS OF THE FIRE SAFETY EQUIPMENT, CAVITY BARRIERS ETC.

FIRST FLOOR
FIRE EQUIPMENT
PLAN

ROYAL LONDON
HOUSE

RLH/FP/1E

SCALE 1:200 at A3
MAY 2010

