

DATE	REVISION
A 1.2.12	MALE & FEMALE WCs SWAPPED & GENERAL UPDATE FOLLOWING SITE SURVEY
B 5.4.12	UPDATE FOLLOWING FSO SURVEY
C 9.1.15	FIRE EXTINGUISHER TYPE & POSITIONS UPDATED FOLLOWING FSO's SURVEY
D 3.1.16	UF01 UPDATED TO 'STORE'
E 18.5.17	VARIOUS ROOMS UPDATED TO 'VACANT'

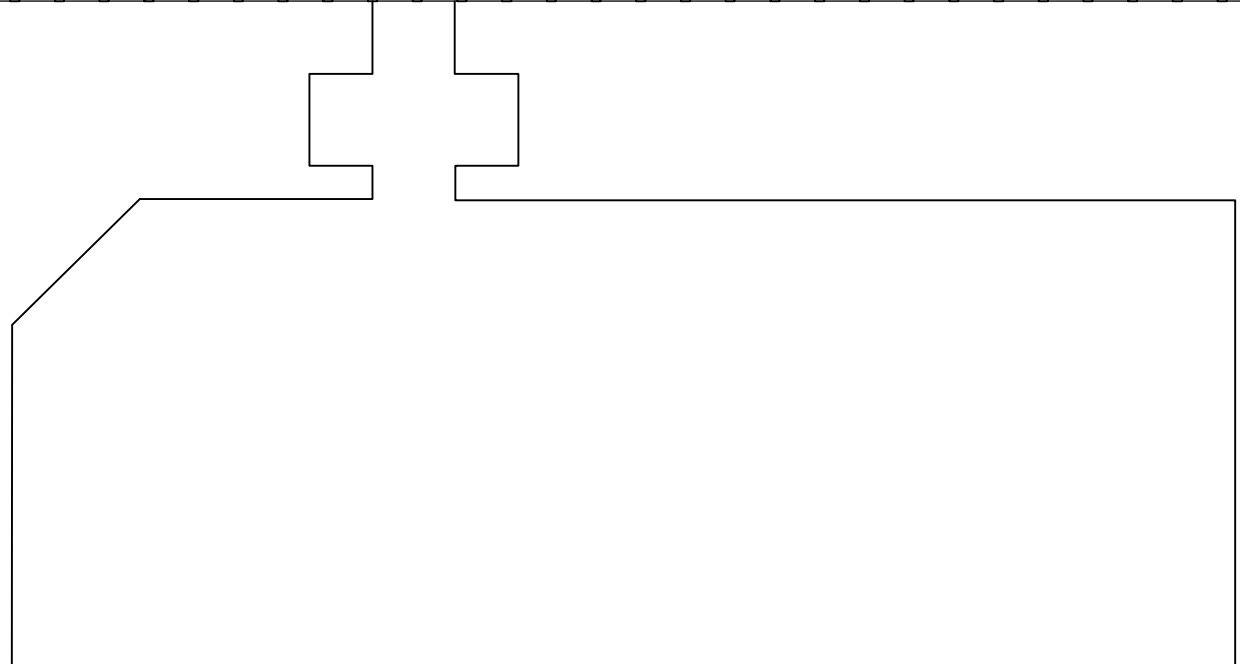
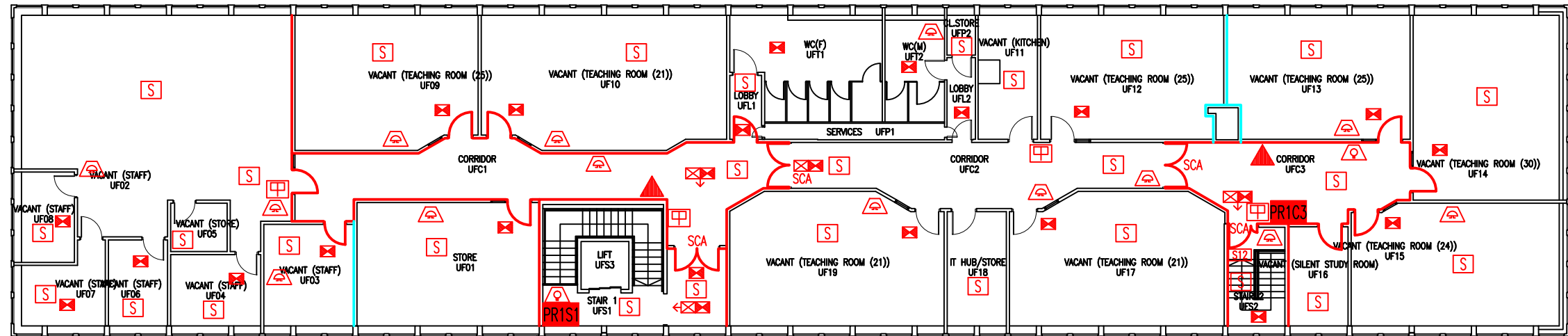

NB1: LAYOUT BASED ON SURVEY BY NIGHTINGALE ARCHITECTS.

- Key to Fire Symbols (existing)
- Existing fire resisting construction 30 min.
 - Existing cavity barrier
 - Existing wheelchair refuge zone
 - Denotes directional arrow on existing fire exit sign
 - Existing exit sign - internally illuminated
 - Existing emergency lighting luminaire - self contained
 - Existing call point - manual
 - Existing audible warning device - bell
 - Existing visual warning device
 - Existing smoke detector
 - Existing self closing automatic release
 - Existing 6 litre P50 fire extinguisher
 - Existing fire action sign - general

FIRST FLOOR
FIRE PLAN

PRESTON ROAD,
YEOVIL

PR/FP/3E

SCALE 1:200 at A3
OCTOBER 2008

