

DATE	REVISION
A 20.12.06	PLAN UPDATED FOLLOWING INSTALLATION OF DDA LIFTS
B 4.9.07	SERVICES AREA ADDED IN PG60 NEW EXTERNAL DOORS ADDED IN SPORTS HALL DOOR POSITION OF PG42 AMENDED DEMT WALL REMOVED FROM PG63
C 6.10.08	PLAN UPDATED FOLLOWING REFURB TO ATRIUM
D 2.2.11	PLAN UPDATED FOLLOWING FSD SURVEY
E 16.9.11	PS51 COMBINED WITH PS52 & PS53 TO FORM LARGER FITNESS SUITE PLAN UPDATED FOLLOWING WORKS TO FORM SANTANDER BANK
F 31.8.12	PLAN UPDATED FOLLOWING REFURBISHMENT TO SPORTS HALL & SPORTS RECEPTION AREA
G 30.11.12	UPDATE FOLLOWING CONSTRUCTION OF BIOMASS BOILER
H 8.3.13	PLAN UPDATED FOLLOWING WORKS TO PG63 FOR HSC
J 11.04.13	MAXIMUM OCCUPANCY OF PG60 ADDED AS FSD COMMENTS
K 21.8.13	PLAN UPDATED FOLLOWING WORKS TO PG48 & PG49 SUB-STATION ADDED
L 30.9.14	MAXIMUM OCCUPANCY OF ATRIUM ADDED AS FSD COMMENTS
M 20.1.15	"CLEAR AREA" OUTLINE ADDED TO ATRIUM
L 10.9.15	STUDENT CENTRE OUTLINE, SHARED DOORS & WINDOWS & SPORTS RECEPTION LINK ADDED
M 17.11.16	UPDATE FOLLOWING REFURBISHMENTS TO PG47-48 & PG60-PG61 & PG63-63a
N 3.10.18	PS59a CHANGED TO "VACANT" FOLLOWING REMOVAL OF ATM
P 30.7.20	DOOR BETWEEN PG60 & PG61 REMOVED
Q 12.2.21	PG40 AREA UPDATED FOLLOWING SANTANDER EXIT & "SS" MOVE FROM MELBURY HOUSE
R 3.8.21	PG40 AREA UPDATED FOLLOWING REFURBISHMENT

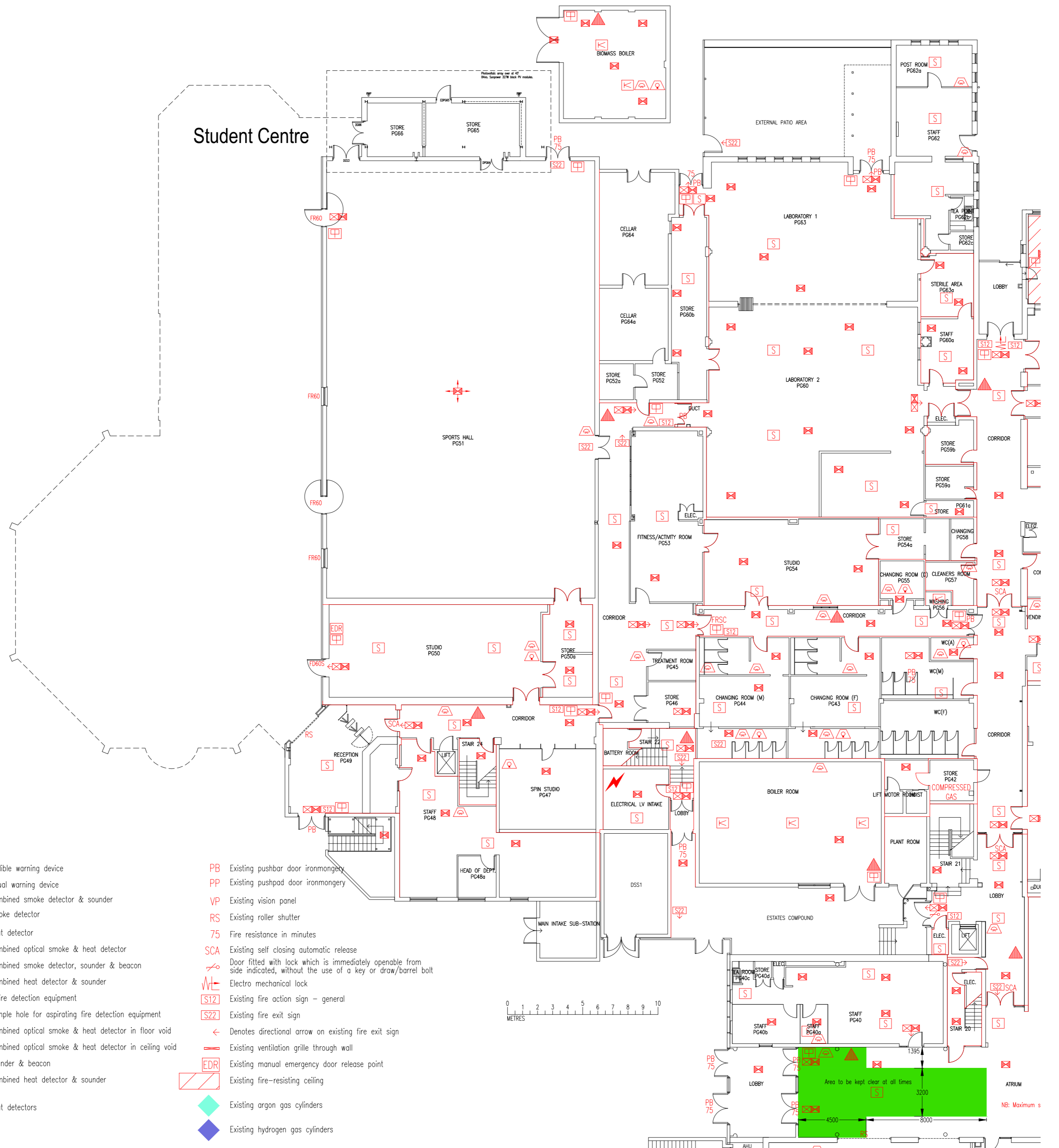

FR /cavity barrier lines are based on a survey & remedial works carried out by Oak Leaf & Nene Valley Fire. Some doors may have "Fire Door" signage attached but be within a wall that is not shown as FR on this plan. This is because some walls have been assessed as non-FR compliant during the survey & remedial works. Therefore, these doors & walls should be regarded as non-FR.

Key to Fire Symbols

- Existing fire resisting construction 30 min.
- Existing cavity barrier
- Existing smoke damper controls
- Existing Evac chair
- Existing fire alarm control panel
- Existing premises information board
- Existing dry riser inlet
- Existing dry riser outlet
- Existing 6 litre P50 foam fire extinguisher
- Existing fire blanket
- Existing call point - manual
- Existing exit sign - internally illuminated
- Existing emergency lighting luminaire
- Area covered by existing emergency lighting
- Electrical shut-off point for building
- Existing audible warning device
- Existing visual warning device
- Existing combined smoke detector & sounder
- Existing smoke detector
- Existing heat detector
- Existing combined optical smoke & heat detector
- Existing combined smoke detector, sounder & beacon
- Existing combined heat detector & sounder
- Aspirating fire detection equipment
- Existing sample hole for aspirating fire detection equipment
- Existing combined optical smoke & heat detector in floor void
- Existing combined optical smoke & heat detector in ceiling void
- Existing sounder & beacon
- Existing combined heat detector & sounder
- Existing heat detectors
- Existing pushbar door ironmongery
- Existing pushpad door ironmongery
- Existing vision panel
- Existing roller shutter
- Fire resistance in minutes
- Existing self closing automatic release
- Door fitted with lock which is immediately openable from side indicated, without the use of a key or draw/barrel bolt
- Electro mechanical lock
- Existing fire action sign - general
- Existing fire exit sign
- Denotes directional arrow on existing fire exit sign
- Existing ventilation grille through wall
- Existing manual emergency door release point
- Existing fire-resisting ceiling
- Existing argon gas cylinders
- Existing hydrogen gas cylinders

THIS FIRE SAFETY PLAN IS GENERALLY BASED ON INFORMATION PROVIDED BY BU'S FIRE SAFETY OFFICER. IT IS THE RESPONSIBILITY OF ALL USERS OF THIS PLAN TO CHECK THE INFORMATION PROVIDED TO CONFIRM THE EXACT POSITIONS OF THE FIRE SAFETY EQUIPMENT, CAVITY BARRIERS ETC.

GROUND FLOOR  
FIRE EQUIPMENT  
PLAN

POOLE HOUSE  
SPORTS BLOCK

PH/S/FP/1R

SCALE 1:200 AT A2  
SEPTEMBER 2005

