

DATE	REVISION
W 17.11.16	UPDATE FOLLOWING WORKS TO FORM PG22 & PG16. PG34 SEATS & BENCHES LAYOUT UPDATED.
X 7.6.17	PG30 DOOR POSITION UPDATED
Y 3.10.17	PG25 EXTERNAL DOOR & COMPOUND ADDED. PG33 UPDATE TO SEATING LAYOUT & CAPACITY FOLLOWING REFURBISHMENT.
Z 8.1.19	PG126 UPDATED TO "VACANT".
AA 4.4.19	UPDATE FOLLOWING SURVEY & WORKS TO CAVITY BARRIERS
AB 30.7.20	PG11 & PG11a CHANGED TO "SPORTS THERAPY".
AC 12.2.21	PG16 CHANGED TO "STORE". PG18 CHANGED TO "VACANT".
AD 21.4.22	PG30a CHANGED TO "STORE". PG30b CHANGED TO "STAFF".
AE 4.10.22	UPDATE FOLLOWING REFURBISHMENT TO PG16 AREA & ALTERATIONS TO PG22.
AF 4.4.23	UPDATE FOLLOWING REFURBISHMENT TO PG10a-d TO CREATE 'CHANGING ROOMS'.

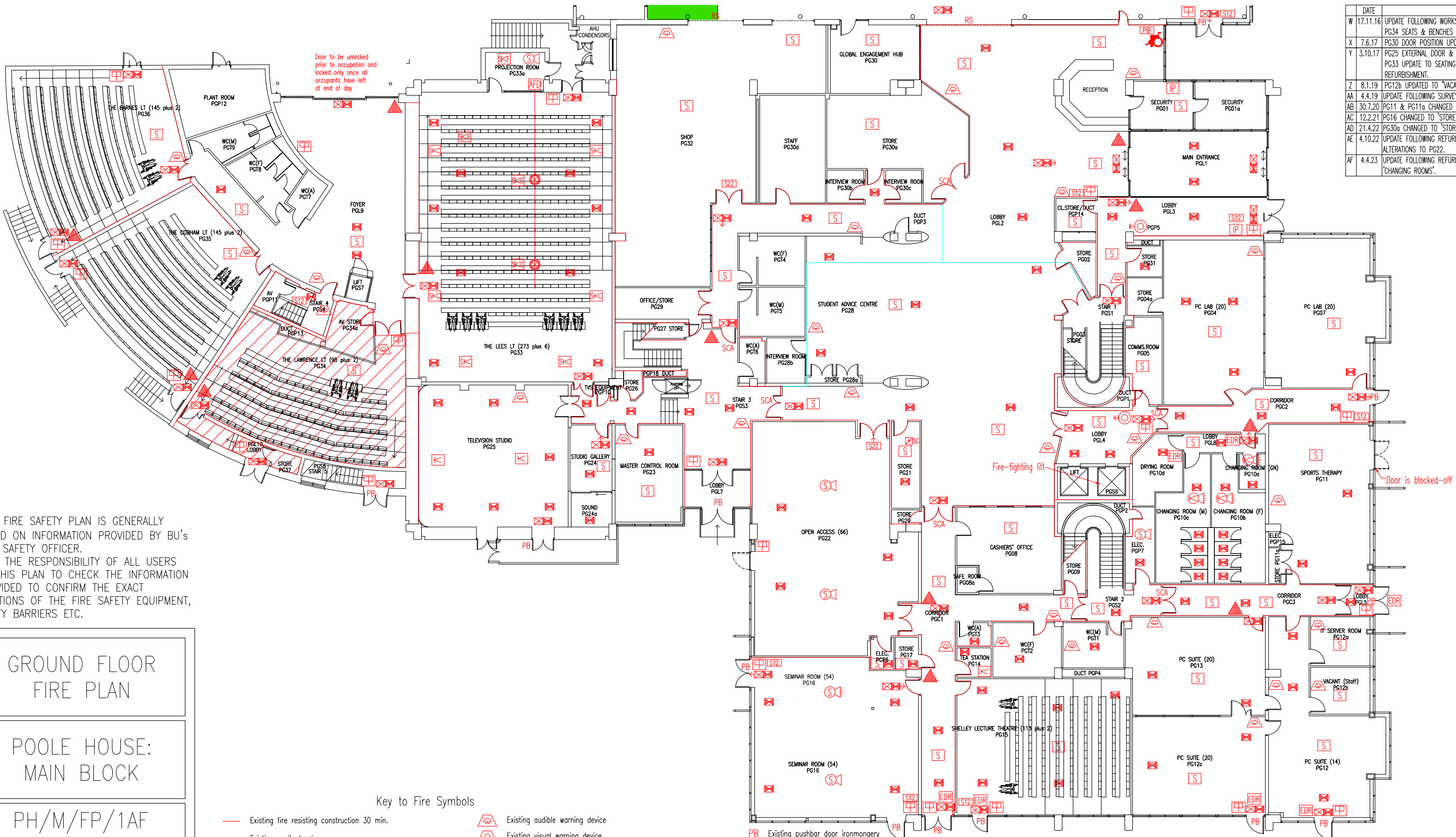

THIS FIRE SAFETY PLAN IS GENERALLY BASED ON INFORMATION PROVIDED BY BU'S FIRE SAFETY OFFICER. IT IS THE RESPONSIBILITY OF ALL USERS OF THIS PLAN TO CHECK THE INFORMATION PROVIDED TO CONFIRM THE EXACT POSITIONS OF THE FIRE SAFETY EQUIPMENT, CAVITY BARRIERS ETC.

**GROUND FLOOR
FIRE PLAN**

**POOLE HOUSE:
MAIN BLOCK**

PH/M/FP/1AF

SCALE 1:250 at A3
SEPTEMBER 2005



Key to Fire Symbols

- Existing fire resisting construction 30 min.
- Existing cavity barrier
- Existing smoke damper controls
- Existing Evac chair
- Existing fire alarm control panel
- Existing premises information board
- Existing dry riser inlet
- Existing dry riser outlet
- Existing 6 litre P50 foam fire extinguisher
- Existing fire blanket
- Existing call point - manual
- Existing exit sign - internally illuminated
- Existing emergency lighting luminaire
- Area covered by existing emergency lighting
- Electrical shut-off point for building
- Existing audible warning device
- Existing visual warning device
- Existing combined smoke detector & sounder
- Existing smoke detector
- Existing heat detector
- Existing combined optical smoke & heat detector
- Existing combined smoke detector, sounder & beacon
- Existing combined smoke detector & sounder
- Existing combined heat detector & sounder
- Existing combined heat detector, sounder & beacon
- Aspirating fire detection equipment
- Existing sample hole for aspirating fire detection equipment
- Existing combined optical smoke & heat detector in floor void
- Existing combined optical smoke & heat detector in ceiling void
- Existing sounder & beacon
- Existing combined heat detector & sounder
- Existing heat detectors
- Existing pushbar door ironmongery
- Existing pushpad door ironmongery
- Existing vision panel
- Existing roller shutter
- Fire resistance in minutes
- Existing self closing automatic release
- Door fitted with lock which is immediately openable from side indicated, without the use of a key or draw/barrel bolt
- Electro mechanical lock
- Existing fire action sign - general
- Existing fire exit sign
- Denotes directional arrow on existing fire exit sign
- Existing ventilation grille through wall
- Existing manual emergency door release point
- Existing fire-resisting ceiling
- Existing argon gas cylinders
- Existing hydrogen gas cylinders

FR /cavity barrier lines are based on a survey & remedial works carried out by Oak Leaf & Nene Valley Fire. Some doors may have "Fire Door" signage attached but be within a wall that is not shown as FR on this plan. This is because some walls have been assessed as non-FR compliant during the survey & remedial works. Therefore, these doors & walls should be regarded as non-FR.

