

DATE	REVISION
A SEPT.09	BC01-BC06 AREA REFURBISHED, BC01 COMBINED WITH BC03
B 28.9.10	CHEMICAL LIST ADDED FOLLOWING FSO SURVEY.
C 12.9.11	BC06 & BC06a CHANGED TO TEMPORARY EIS STORES, BC10 LECTURE THEATRE SEATING UPGRADE.
D 16.5.12	UPDATE FOLLOWING WORKS TO RELOCATE SU SHOP & LOUNGE
E 3.9.12	UPDATE FOLLOWING WORKS TO REFURBISH LABS & ASSOCIATED AREAS
F 22.10.12	UPDATE FOLLOWING FSO'S SURVEY
G 8.1.13	MAXIMUM CAPACITY ADDED TO BC23 FOLLOWING REQUEST FROM FSO
H 21.2.13	CAVITY BARRIER DETAILS UPDATED AS REQUESTED BY FSO
J 13.9.13	BC17 EXTENDED. BC17a DELETED
K 2.2.15	UPDATE TO SHOW CORRECT FIRE COMPARTMENTATION BETWEEN BC21 & BC22. UPDATE FOLLOWING WORKS TO CREATE HSC STORES BC08 & BC19. CROSS CORRIDOR DOORS REMOVED OUTSIDE BC22
L 13.3.15	BC12 CHANGED TO WC(F)
M 20.8.15	BC16 CHANGED TO 'STORE'
N 7.10.15	BC05 CHANGED TO 'STORE'
P 26.8.16	GAS BOTTLE STORE ADDED
Q 19.9.16	EXTINGUISHER POSITIONS & TYPES UPDATED
R 14.2.18	BC27 "SECURITY" GIVEN DISTINCT ROOM NUMBER
S 21.5.18	BC06 & BC06a UPDATED TO "VACANT"
T 11.1.19	BC06 UPDATED TO 'UNIFORM STORE' & BC06a UPDATED TO 'STORE'.

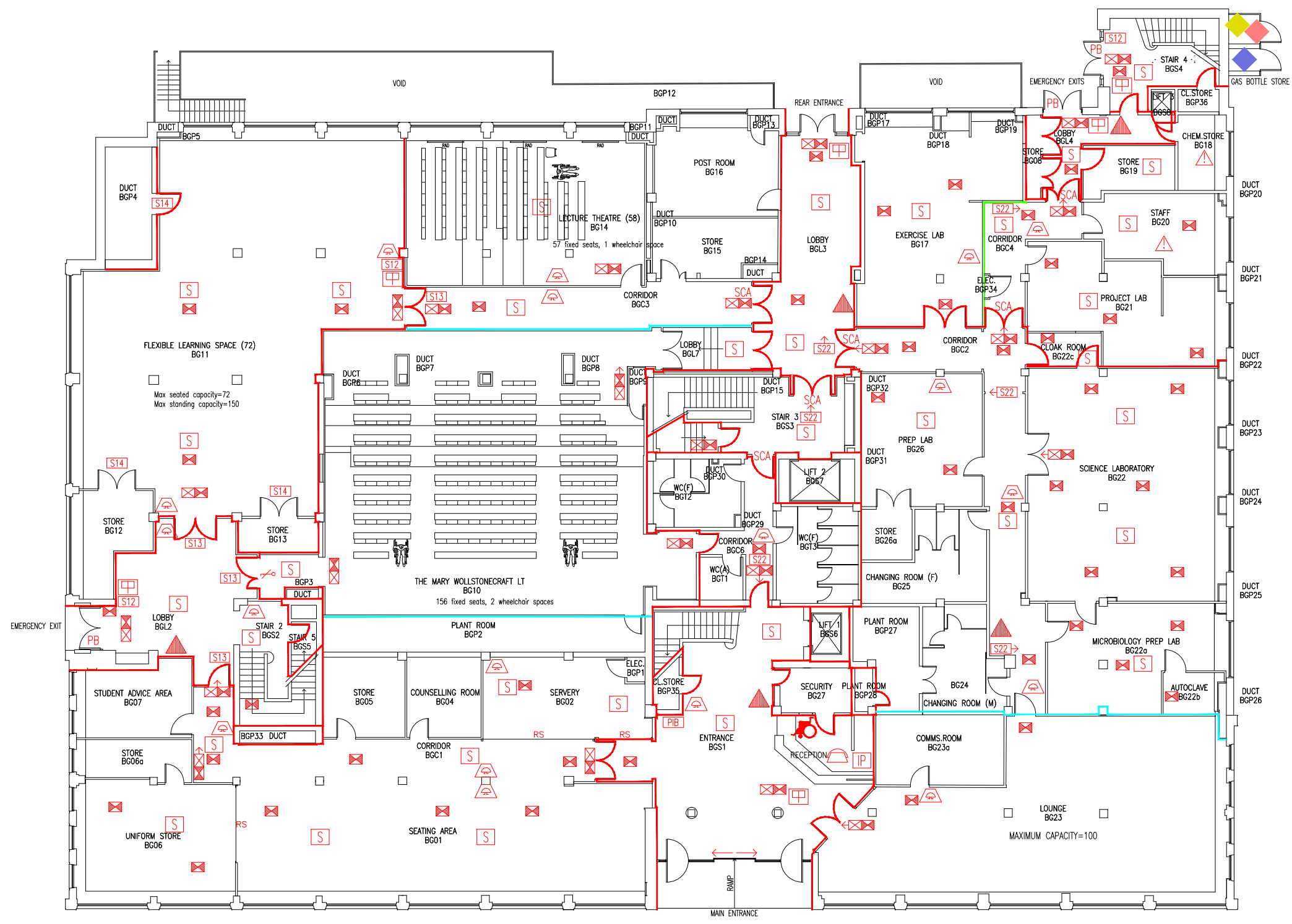

- Key to Fire Symbols :
- Existing fire resisting construction 30 min.
  - Existing cavity barrier
  - Denotes line of fire resisting construction required
  - Wheelchair refuge intercom master panel
  - Existing fire alarm control panel
  - Existing Evac chair
  - Existing premises information board
  - Denotes presence of chemicals - details in PIB
  - Existing nitrogen gas cylinders
  - Existing oxygen gas cylinders
  - Existing hydrogen gas cylinders
  - SCA Existing self closing automatic release
  - Existing 6 litre P50 foam fire extinguisher
  - Existing call point - manual
  - Existing emergency lighting luminaire - self contained
  - Existing exit sign - internally illuminated
  - Existing audible warning device - bell
  - S Existing smoke detector
  - PB Existing pushbar door ironmongery
  - S12 Existing fire action sign - general
  - S13 Existing fire safety sign - fire door keep shut
  - S14 Existing fire safety sign - fire door keep locked
  - S22 Existing fire exit sign
  - ← Denotes directional arrow on existing fire exit sign
  - RS Roller shutter

THIS FIRE SAFETY PLAN IS GENERALLY BASED ON INFORMATION PROVIDED BY BU'S FIRE SAFETY OFFICER. IT IS THE RESPONSIBILITY OF ALL USERS OF THIS PLAN TO CHECK THE INFORMATION PROVIDED TO CONFIRM THE EXACT POSITIONS OF THE FIRE SAFETY EQUIPMENT, CAVITY BARRIERS ETC.

GROUND FLOOR  
FIRE PLAN

BOURNEMOUTH  
HOUSE

BH/FP/2T

SCALE 1:200 at A3  
OCTOBER 2008

